

Baseball Bash Game Elements

Table of Contents

Appendix C – Baseball Bash Playing Field.....	2
C.1 – Description	2
C.2 – Bill of Materials	2
C.3 – Tower	3
C.5 – Bases and Home Plate.....	5
C.5 – Pitcher’s Mound	5
C.6 – Parking Platforms.....	7
C.7 – Bonus Ball.....	7
C.8 – Rope Attachment Plates	7
C.9 – Element Placement.....	9

Appendix C – Baseball Bash Game Elements

C.1 – Description

This appendix contains information on the construction and placement of the game elements used in Baseball Bash.

C.2 – Bill of Materials

The table below contains the materials needed for a single set of Baseball Bash game elements.

Game Elements

Item	Type	Price per piece	Quantity	Line Total	Source	SKU#
Plastic Baseballs	2 pack	\$1.97	2	\$3.94	Walmart	22988562
Ball Pit Balls	pack	\$11.53	1	\$11.53	Walmart	9221101056
Cones	set of four	\$3.50	1	\$3.50	Walmart	2980789930
NDS 3-in x 4-in Dia PVC Coupling Fitting	each	\$2.58	1	\$2.58	Lowe's	22690
Charlotte Pipe 4-in Dia PVC Coupling Fitting	each	\$2.11	1	\$2.11	Lowe's	23284
1/4" dowel	4 feet	\$0.78	4	\$3.12	Lowe's	19377
3/4" dowel	4 feet	\$2.97	2	\$5.94	Lowe's	19384
Duct Tape (Red)	roll	\$3.47	1	\$3.47	Lowe's	369273
1/8" hardboard	4'x8' sheet	\$13.04	1	\$13.04	Lowe's	16605
Golf Ball (orange)	piece		1			

Game Elements Total \$49.23

Field	Type	Price per piece	Quantity	Line Total	Source	SKU#
Field Border Set	Set	\$99.00	1	\$99.00	Higher-Order Innovation	10035
Foam Mats	8 mat pack	\$24.00	3	\$72.00	Sams	276459

Field Total \$171.00

C.3 – Tower

This section contains information for the creation of the Tower that is used in *Baseball Bash*.

Materials

- 1 PVC coupler
- 1 PVC S&D
- PVC glue (recommended)

Steps

1. Place coupler onto S&D. The assembly should be 6.75" tall. Glue or tape into place if fit is loose.

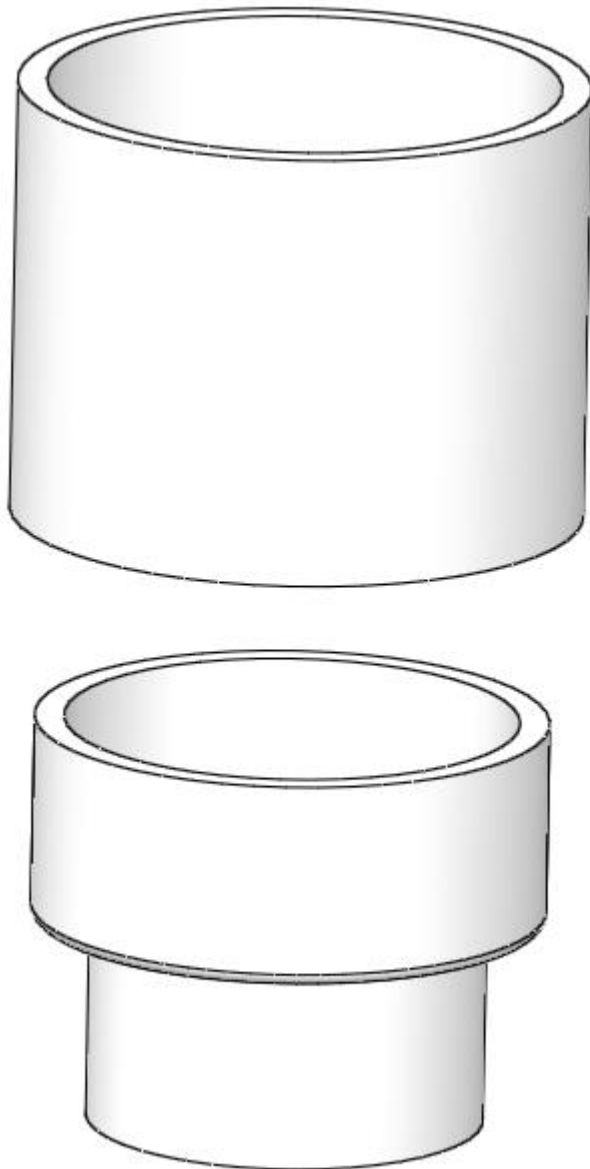

C.4 – Bases and Home Plate

This section contains information for the creation of the three Bases and Home Plate that is used in *Baseball Bash*.

Materials

1/8" hardboard sheet
1/4" doweling
3/4" doweling
Red Duct Tape
Method of cutting hardboard and doweling
Tape measure or ruler

Description

1. Cut one (1) square each of 9", 12", 15", and 18". These form Home Plate, Third Base, Second Base, and First Base respectively.
2. To complete the Home Plate, tape two (2) lengths of the 1/4" doweling and two (2) lengths of the 3/4" doweling to the top surface along the edges. The 3/4" dowels should share a common corner.
3. Each of the other squares (first, second, and third) should have three (3) lengths of 1/4" and one (1) length of 3/4" doweling.

C.5 – Pitcher's Mound

This section contains information for the creation of the *Pitcher's Mound* that is used in *Baseball Bash*.

Materials

1/8" hardboard sheet
Method of cutting hardboard
Tape measure or ruler

Description

1. Cut one (1) 9" x 9" square from the hardboard

C.6 – Parking Platform (2x)

This section contains information for the creation of the Parking Platforms that are used in *Baseball Bash*. The white side is considered the top.

NOTE: It is the intent of the CREATE Foundation to reuse components of the field as possible. These platforms represent one of those building blocks that may be reused.

Materials

1/8" hardboard sheet
Method of cutting the hardboard
Tape measure or ruler

Steps

2. Cut two (2) 15" x 15" squares from the hardboard

C.7 – Bonus Ball (1x)

The bonus ball is one (1) orange golf ball. The ball may either be naturally orange or spray painted.

C.8 – Rope Attachment Plates

The border of the field is created through the combination of 5/8" rope and custom rope anchor points. The location and configuration of these anchors is game dependent and is outlined in the figures and description below.

10 plates will be used in Baseball Bash. There are three different arrangements of the rope anchors. Unless otherwise noted, the top of the plate with holes 1, 2, and 3 is oriented toward the center of the field. When placing anchors, keeping the rope taut will produce better results.

1. Eight (8) are standard straight edged plates with posts attached at 11 and 13.
2. One (1) is a single-point corner with a single post attached to 7.
3. One (1) is a three-point corner with posts attached at 1, 11, and 13. (example shown below)

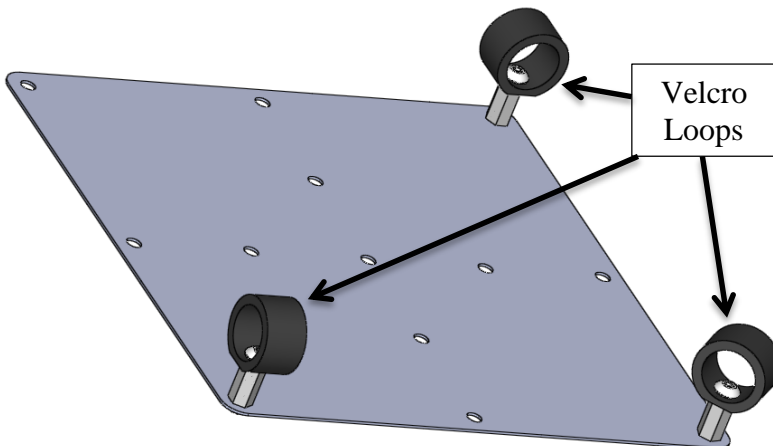
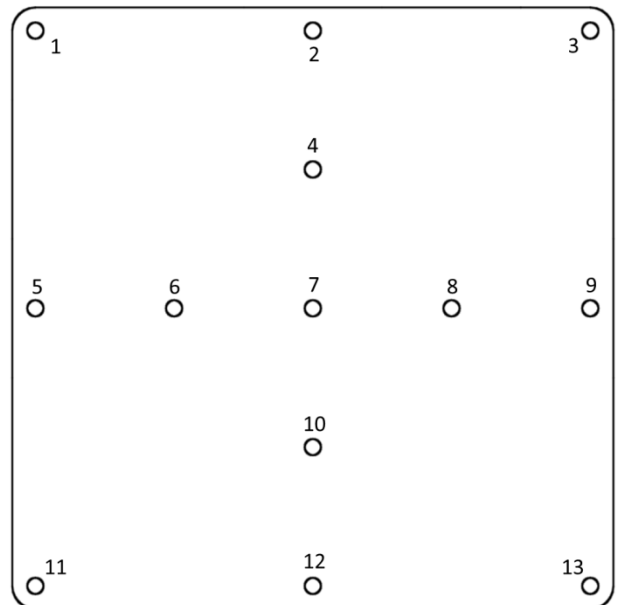

C.9 – Element Placement

All descriptions are based off of the figure shown below.

The Rope Attachment Plates are organized as shown below. The plates should be hidden under the foam tiles. The standoff is fed through the seam of the tiles with the Velcro on the top surface. The Velcro is then looped over the rope and attached to itself. The rope should be pulled taught as necessary to provide the best results.

The Bases are arranged as below. The edge with the thicker dowel is placed along the rope border.

Each Base has a cone centered on it with a softball placed on top.

Home Plate is set in the lower right corner. The thick dowels are placed along the rope border.

Five stacks of the medium sized balls are arranged as below. These stacks are four balls topped with a fifth. Color coordination of the medium sized balls is not necessary.

The pitcher's mound is placed in the center of the field. It is underneath the center set of balls in the figure below.

The tower is placed with the wide end down, centered on the pitcher's mound. A cone is inverted on the top of the tower with one ball in the bottom of the cone and five more on top.

The bonus ball starts inside the tower, resting on the pitcher's mound.

The parking platforms are set up as below with one edge running along the edge of the field.

